

Catalog Number	
Notes	Type



PFC6 SERIES

*Thermoplastic
Injection Molded*

Emergency Unit

Internal Molded Heads

6 Volt

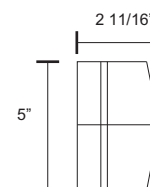
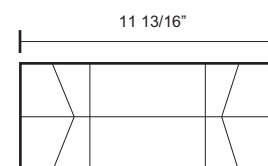

Description:

The PFC6 Series is the ideal economical choice for basic emergency lighting. The one piece unit body is injection molded using color stable, high impact UL 94-5V rated polycarbonate material. Emergency output is provided from two internally molded heads, with flush molded prismatic lenses. No external heads are visible, providing a slim, almost invisible profile. The PFC6 unit provides 6 volt output, ranging from 10 through 15 watts rated for 90 minutes. Unit can be wall or ceiling mounted.

Electrical:

- Dual voltage input, 120/277 VAC. Contact factory for other voltages.
- Line latching.
- Constant current solid-state voltage limited charge.
- Solid-state transfer switching.
- Circuit design includes brownout protection, low voltage battery disconnect, and short circuit protection.
- Circuit board includes momentary test switch and AC-ON visual indicator.

Housing:

- Injection molded of polycarbonate, high impact UL 94-5VA material.
- Housing color will not vary with prolonged exposure to UV radiation.
- Standard finish is white.
- Universal J-box mounting pattern.
- Unit can be wall or ceiling mounted. Keyhole mounting slots are provided.
- All components of of snap-fit construction.
- Housing includes cutout for surface mounted conduit use.
- Minimal installation wiring is needed.

Lamp Heads:

- Lamp heads are molded flush to the housing. No external head assembly is visible. Front lens assembly is injection molded from crystal clear acrylic with precision molded linear spread pattern for efficient lumen output.
- Emergency lamp output can be directed either horizontally or straight down by reversing the prismatic lens covers.

Battery:

- Sealed maintenance-free Lead Calcium, recombinant cell.
- The battery is protected from deep discharge by a low voltage disconnect circuit.
- 90 minutes minimum discharge.

Lamps:

- Emergency lamp heads use wedge base, T5, tungsten high lumen output. Standard unit utilizes 5.4watt heads.

Listing/Code Compliance:

- UL 924 listed
- Life Safety NFPA 101, NEC/OSHA

Warranty:

- Battery, 5 year pro-rata
- Charger board, 5 years

ORDERING INFORMATION

SAMPLE CAT#: PFC6-10

PFC6							
Series	Voltage/Wattage	Options	Accessories				
PFC6	10	6 volt/10watt		GXPE	Wire Guard		
	15	6 volt/15watt		VRBPU	Vandal Bubble		
				3CP	120V,cord & plug		
				37CP	277V,cord & plug		

ENERGY DATA

Charge Mode (Fully Discharged Battery)

PFC6-10 Series (Lead Calcium Battery)
PFC6-15 same

Unit	Input (VAC)	Input Current (ma)	Watts
PFC6-10	120	40	4.4
	277	23	6.7

Note: Figures based on fully discharged battery on high charge.



Office: 718-418-5600 • Fax: 718-418-5618
57-10 49th Place • Maspeth, N.Y. 11378
www.encorelighting.com

P/N75-1016 (02/11)